

Oakparkkampground.com
info@oakparkkampground.com

Oak Park Kampground

FUN FAMILY CAMPING!

9561 County Road 8 NW
Garfield MN, 56332
320-834-2345

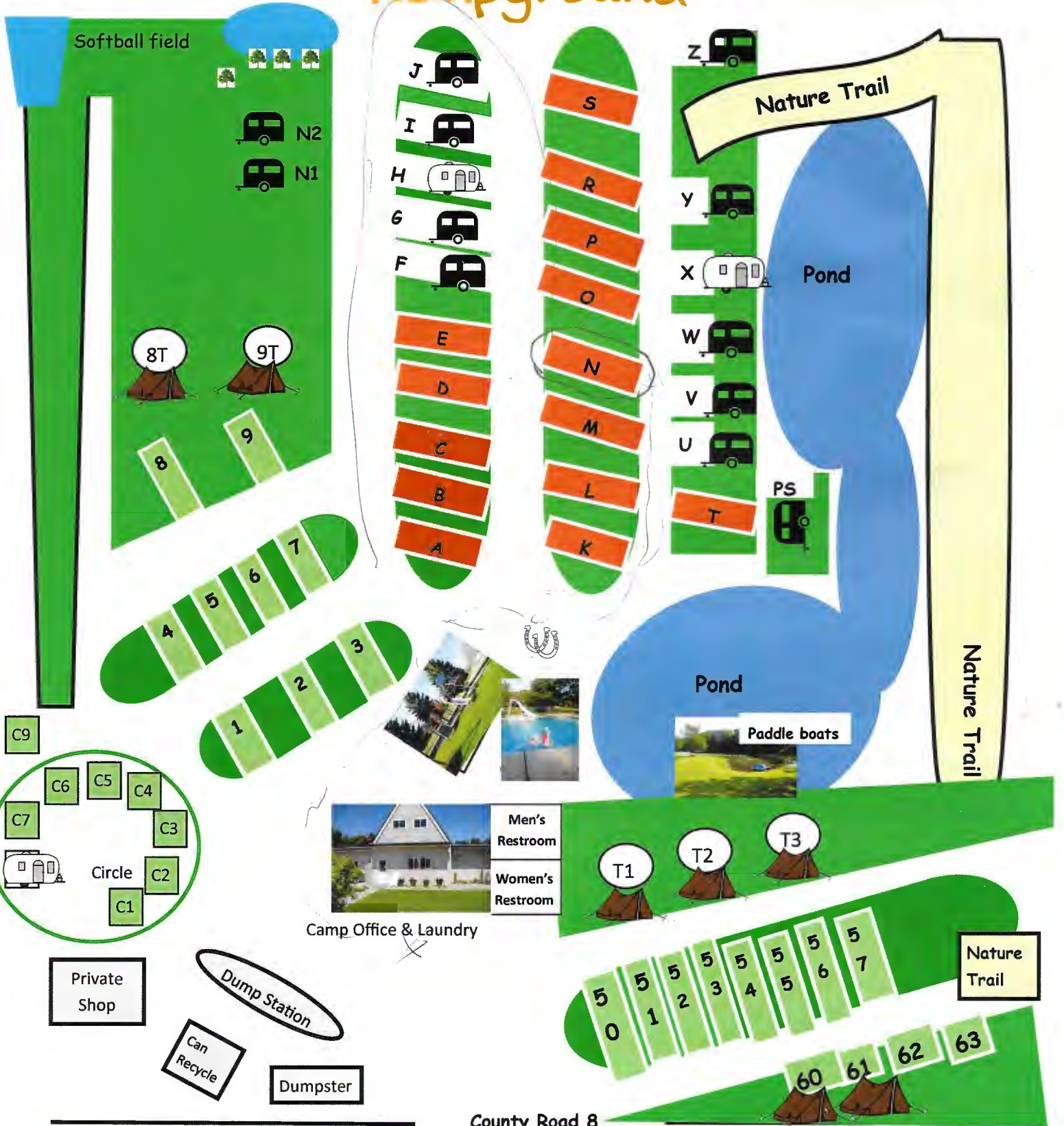

- = Water & Electric Sites
- = Full Hook Up
- = No Hook Up
- = Seasonal or Monthly Site
- = Camp Host

Welcome to Oak Park Kampground
Please review our Guidelines for Happy Camping!

These guidelines have been established for your safety and to allow you and your fellow campers to enjoy a memorable stay at Oak Park Kampground. Please understand that we are a family campground. Please discuss these guidelines with all members of your family and any visitors. Thanks!

CHECK OUT TIME: 12:00 pm Early arrival or late check out may be arranged with the office if site is available.

GUESTS: State law requires that all guests and visitors register at the office before entering the Park. Visitor hours are from 8am until 10pm. We reserve the right to refuse entrance to any and all visitors. Visitor fee of \$2 per person is charged.

VEHICLES: Please park camper and all vehicles on the gravel pad, not on the grass. Only 2 vehicles allowed per site. Extra vehicles must be park in overflow parking.

RESTROOMS: Closed for cleaning daily, as posted.

QUIET HOURS: 11 pm to 7 am. Please respect the tranquility of neighboring campers, all outdoor radios/TVs must be turned off during quiet hours and voices should be at a whisper. We ask that all awning lights go out at quiet time. Taste in music varies considerably, please keep the volume of radios, TVs etc. maintained such that it is not heard beyond your site at all times. Playground is closed at dusk until 7 am. Children under 18 must return to their campsite by 10 pm.

ALCOHOL/DRUGS: Adults are welcome to consume alcoholic beverages, (in moderation please!), on their campsite only. Off your site it should be in a container such that it is not displayed.. Absolutely No non-prescription drugs allowed on property. Abuse of alcohol or drugs will be cause for immediate eviction without refund..

PROFANITY: Please refrain from using profanity while in the park .

FIREARMS/FIREWORKS: The use of firearms, bows and arrows, slingshots or fireworks of any type are not allowed on park grounds.

SPEED LIMIT & ROADS: 5mph will be enforced for the safety of all campers.. Please leave your Motor Bikes/ATV's and Golf Carts at home unless otherwise approved by management.

WASHING/MAINTENANCE: of Vehicles or Trailers is not permitted without permission from management.

BACKFLOW PREVENTION: Is required by the MN Health Department. If you do not have a backflow valve, we do have then available for loan at the camp store.

FIREWOOD: Most people choose our campground due to our beautiful trees, to protect them, we ask that firewood not be brought into the campground.

OUTSIDE MATS/RUGS: Please do not leave a mat or rug down for more than a 72hr period, so that it does not kill the grass.

CAMPFIRES: Please use the fires rings provided for your fires, where they are on the site. Due to the wooded nature of our campground please **completely** extinguish all fires before you retire for the evening or leave the campsite. Please do not cut or damage any trees or vegetation within the park.

PETS: Campground friendly pets are allowed, please be sure to read and abide by our "People Owner Courtesies".

SUPERVISION: Parents are responsible tor the safety and behavior of their children. Young children should be supervised by an adult at all times in the park.

BICYCLES: For your safety we do not allow bike riding after sunset in the campground. Bicycles must obey 5mph speed limit. Please ride only on roads or trails.

PADDLE BOATS: Paddle boats can be signed out by an adult in the office, all riders must wear life jackets and children must be 10 yrs. or older to be on the boat without an adult. Boats can be checked out between the hours of 8:30 am and sunset.

POOL: NO LIFE GUARD ON DUTY SWIM AT YOUR OWN RISK. Food or drink are allowed on the pool deck but not in the pool. NO GLASS CONTAINERS. No one can be in the pool alone. Children who are accomplished swimmers age of 15 and over may enter the pool, all other children **MUST** be accompanied and supervised by an adult (someone 18 or over) at all times at the pool. Additional POOL RULES are posted at the pool and must be read and observed.

We are not responsible for accidents or injury to our guests and/or damage of personal belongings while camping at our Campground.

FISHING & SWIMMING

Latoka Beach: Is located 8 miles from the park. Go left out of the park, at the second stop sign turn right, then look for signs on your right.

Lake Mina Public Boat Access: Go left out of the park, access is located

In Case of Emergency Dial 911

Incase of Tornado We are located in Douglas County.

Should we have a tornado warning the Air Horn will blow long blows, please come to the basement of the main building.

We do hope your stay is a pleasant one. Please stop by the office if you need help or information .

Thanks for staying with us. Oak Park Management



*Where Happiness is a Campfire
with
Family and Friends.*

Open April 15—November 15
weather permitting



9561 County Road 8 NW
Garfield, MN 56332
320-834-2345

info@oakparkkampground.com

Amenities

Pull Through Sites
Full Hook Up Sites, 30amp
Water & Electric Sites, 30amp
Tent Sites
Hot Showers
WI-FI in office Building
Swimming Pool
Hiking Trails
Pedal boats
Dump Station
Coin op Laundry
Pets welcome
Playground
Basket Ball
Softball Field
Bocce Ball



Family Camping in the Alexandria Lakes area

Located in Garfield, Minnesota, just six miles from Alexandria, Oak Park Kampground is the ideal location for your family's summer camping adventure. With 59 RV sites arranged on 43 acres of rolling hills and mature trees, an outdoor pool, a softball field, horse shoe pits, and close access to area fishing and attractions, there is definitely something for everyone.

Make your camping experience even more fun, by participating in our weekend events, see the insert for more details or visit oakparkkampground.com

Area Attractions

Fishing
Golf Courses
Maritime Museum
Runestone Museum
World's Largest Viking
Stock Car Racing (Sat. Night)
Antiquing in Alexandria
Central Lake Bike Trail
Carlos Creek Winery
Lakes Country Wines
L'homme Dieu Theatre
Apple Blossom Farms
Panther Distillery
Erickson's Petting Zoo



Oak Park Kampground

9561 County Road 8 NW

Garfield, MN 56332

320-834-2345

info@oakparkkampground.com

oakparkkampground.com





Directions

Coming from the East:

From I-94: Take Exit 97, turn right onto Co. Rd. 40 go 1 1/2 miles, turn left onto Co. Rd. 8. Oak Park is 1 1/4 miles on your right.

Coming from the West:

From I-94: Take Exit 97, turn left onto Co. Rd. 40 go 1 1/2 miles, turn left onto Co. Rd. 8. Oak Park is 1 1/4 miles on your right.



Hope to see you soon

Rates

Prime Season Rates
(Stay 6 consecutive nights and get the 7th night free.)

Tent Site-No Hook-ups	\$27.94/night
Water/Electric Tent Site.....	\$29.80/night
Water/Electric RV Site.....	\$37.00/night
Water/Electric/Sewage Site	\$39.00/night
Extra Person per Night	\$3.00
Extra Person per Night Holidays.....	\$4.00
Visitor per Day	\$2.00
Visitor per Day Holidays.....	\$3.00

All rates are based on

1 camping unit

with 2 adults and 2 children occupancy.

Max Occupancy 6 people,

4 adults + 2 children or

2 adults + 4 children

Rates do not include MN 7.375% Sales Tax.

Visit oakparkcampground.com
for Pre and Post season rates.

Camping Terms & Conditions

Cancellation Policy: On stays of 29 days or less, if you cancel a full 48 hours prior to 1pm on the day of your scheduled arrival you will receive a full refund. If you cancel 24 hours prior to 1pm on the day of your scheduled arrival you will receive credit for a future stay. If you do not cancel a full 24 hours prior to arrival no refund will be given.

Reservation Deposit: A one night deposit is required for all reservations on non-holiday stays of 30 days or less. Holiday Weekends Require 50% at time of Reservation. Monthly reservations require a deposit of \$50.00.

320-834-2345

Oakparkcampground.com

Info@oakparkcampground.com